

PipeTite®

SEALING OF PIPE ENTRY AND EXIT

Have you ever had the challenge of sealing a sanitary pipe entry or exit in the ceiling, floor or through a wall, in order to achieve a surface which is friendly to clean?

Then PipeTite® is the solution.

The unique design of the silicone body and stainless steel flange both seal against the wall and around the pipe. All this is done without using any additional sealant.

Self-sealing and flexible wall boot

PipeTite® is made of a flexible material which allows movement of the tubes. Vibration and longitudinal movement of the pipe will not affect its ability to seal efficiently.



Installation of PipeTite® is as simple as the product looks - Holes for installation is predrilled and visible rings indicate where to cut.

Facts about PipeTite®

- Available for pipe sizes from 1 to 355mm
- Made of hygienic white silicone, FDA approved
 - flange in Aisi 316 stainless steel
- Operates in temperatures from -50 to +250 °C
- 100% self-sealing - no use of sealant
- Easy to clean and quick to install with pre-drilled holes
- No problems with cracked grout
- Resist's high spray pressure, E.g. during high-pressure cleaning

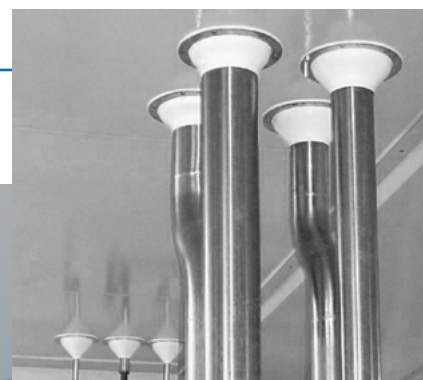

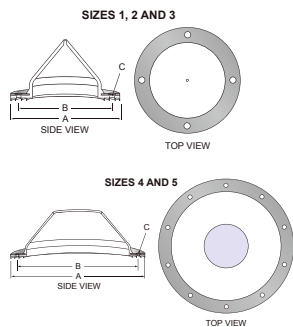

PipeTite sealing ring, standard

Installed to seal on wall, floor and roof.

Size.	Pipe size	A: Base diam.	B: Bolt circl	C: Bore	Holes	Item no.
1	0 - 25	70	57	6,2	4	pt0-25
2	0 - 65	106	91	6,2	4	pt0-65
3	0 - 95	147	128	6,2	6	pt0-95
4	70 - 135	187	168	6,2	6	pt70-135
5	100 - 180	237	213	6,2	10	pt100-180

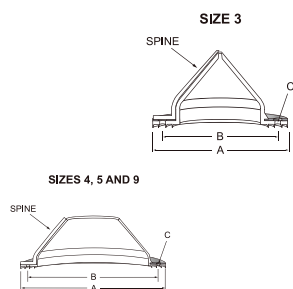

PipeTite sealing ring, Reboot

This seal is mounted on existing installations. Reboot is easily fitted around the pipe and is closed with small staples to ensure that the installation is completely tight.

Size.	Pipe size	A: Base diam.	B: Bolt circl	C: Bore	Holes	Item no.
2	0 - 65	106	91	6,2	5	pt0-65-reboot
3	0 - 95	147	128	6,2	7	pt0-95-reboot
4	70 - 135	187	168	6,2	7	pt70-135-reboot
5	100 - 180	237	213	6,2	10	pt100-180-reboot
7	125 - 275	335	313	6,2	14	pt125-275-reboot
9	180 - 355	490	460	6,2	20	pt180-355-reboot

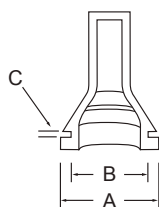

PipeTite sealing ring for panel mounting, hoses

Gaskets that are suitable for small lead-throughs, eg. pipes, cables or air hoses.

Size.	Pipe size	A: Base diam.	B: Bolt circl	Panel thickness	Item no.
1	6	22	16	1,2 - 3,0	pt317135
2	8	22	16	1,2 - 3,0	pt317136
3	10	22	16	1,2 - 3,0	pt317137
4	12	22	16	1,2 - 3,0	pt317138

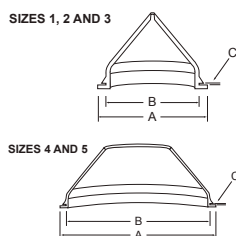

PipeTite sealing ring for panel mounting

Sealant for panel mounting.

Size.	Pipe size	A: Base diam.	B: Bolt circl	Panel thickness	Item no.
1	0 - 25	48	36	1,2 - 3,0	pt317130
2	0 - 65	82	70	1,2 - 3,0	pt317131
3	0 - 95	120	106	1,2 - 3,0	pt317132
4	70 - 135	160	146	1,2 - 3,0	pt317133
5	100 - 180	202	186	1,2 - 3,0	pt317134

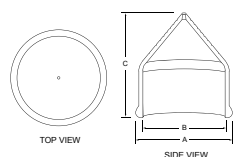

PipeTite sealing ring - pipe to pipe

Sealing of pipe to pipe.

Str.	Rørstr.	A: Outer diam.	B: Inner diam.	C: Height	Item no.
1	100 to 0 - 75	102	90	102mm	pt0-75-PipeNpipe
2	150 to 0 - 135	153	141	153mm	pt0-135-PipeNpipe



PipeTite multi sealing ring

Grommet sealing

Size.	Pipe size	A: Base diam.	B: Bolt circl	Panel thickness	Item no.
1	0 - 25	31	56,7	70	pt0-25-multi

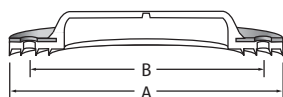

PipeTite flat

For jacketed tank installations

Str.	Rørstr.	A: Outer diam.	B: Inner diam.	Holes	Item no.
2	0 - 65	105	90	4	pt0-65-flat
3	0 - 95	147	128	6	pt0-95-flat
4	0 - 134	186	167	6	pt0-134-flat